

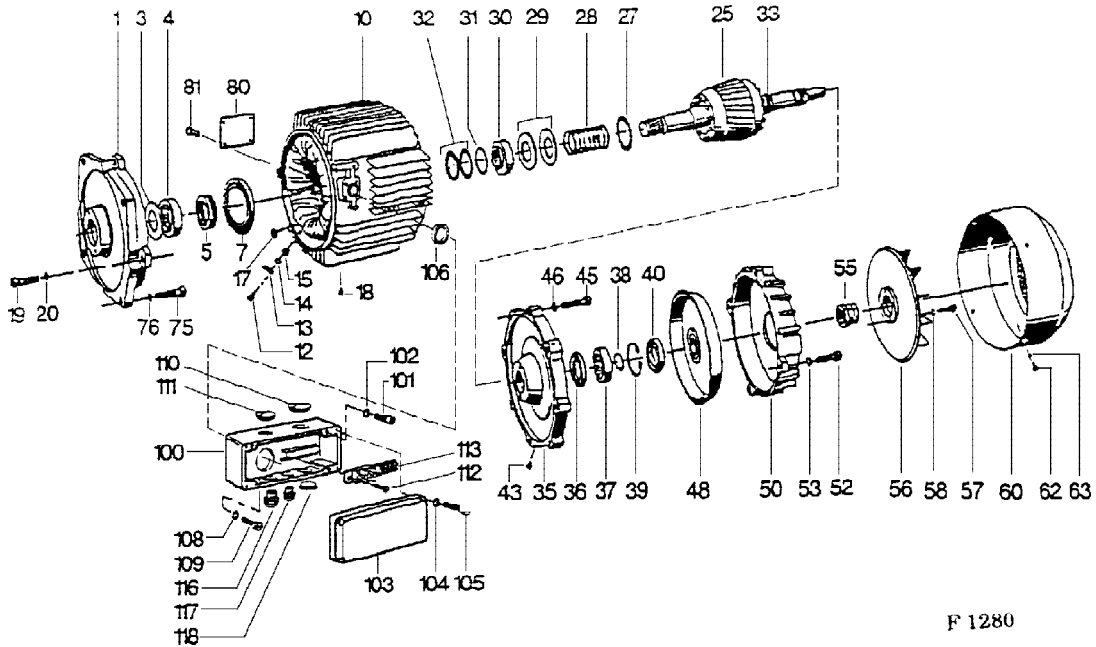

Originalteile  
Original parts  
AS4.



A5



F 1280

| Pos | Teil-Nummer<br>Part-Number | Stück<br>Piece | Beschreibung<br>Description  | Benennung<br>Designation             |                             |
|-----|----------------------------|----------------|------------------------------|--------------------------------------|-----------------------------|
|     | 45 330 88 11 9             | 1              | 2/12A5 1)2) (Pos.1-10,18-76) | Motor Motor                          |                             |
| 1   | 45 330 51 38 0             | 1              | (Pos.3-7)                    | Motorflansch Motor flange            |                             |
| 3   | 04 323 02 53 0             | 1              |                              | Scheibe Disc                         |                             |
| 4   | 560 999 0                  | 1              | RNU 1007 DIN 5412            | Zyl-Rollenlager Roller bearing       |                             |
| 5   | 560 850 0                  | 1              | 51 109 DIN 711               | Axial-Rillenkugellager Axle bearing  |                             |
| 7   | 561 833 0                  | 1              | 70x85x8                      | Wellendichtring Shaft seal           |                             |
| 10  | 45 330 76 12 9             | 1              | 2/12A5 1)3) (Pos.12-17,100)  | Stator Stator                        |                             |
| 12  | 502 069 0                  | 1              | M5x12 DIN 84                 | Zyl-Schraube Cheese head cap screw   |                             |
| 13  | 517 899 0                  | 1              | 0,5-1,5 4) DIN 46225         | Kabelschuh Cable lug                 |                             |
|     | 517 083 0                  | 1              | 2,5-6 4) DIN 46225           |                                      |                             |
| 14  | 506 970 0                  | 1              | A5,1                         | Zahnscheibe Teeth lock washer        |                             |
| 15  | 506 164 0                  | 1              | M5                           | Skt-Mutter Hexagonal nut             |                             |
| 17  | 520 906 0                  | 1              | 3S8                          | Schiebebild Sign                     |                             |
| 18  | 21 253 00 98 0             | 1              |                              | Stopfen Plug                         |                             |
| 19  | 500 307 0                  | 4              | M10x35                       | Zyl-Schraube Socket head cap screw   |                             |
| 20  | 506 904 0                  | 4              | 10                           | Federring Spring washer              |                             |
| 25  | 45 330 07 13 0             | 1              | 2/12A5 5) AS40 : AS50        | Rotor Rotor                          |                             |
|     | 45 330 09 13 0             | 1              | 2/12A5 5) AS51               |                                      |                             |
| 27  | 506 858 0                  | 1              | 45x55x1                      | DIN 988                              | Paßscheibe Adjusting washer |
| 28  | 45 331 01 94 0             | 1              |                              | Druckfeder Pressure spring           |                             |
| 29  | 45 331 01 14 0             | 2              |                              | Tellerfeder Belleville spring washer |                             |
| 30  | 45 331 00 51 0             | 1              |                              | Abstandsring Spacer ring             |                             |
| 31  | 515 955 0                  | 1              | 43x3                         | Runddichtring Round sealing ring     |                             |
| 32  | 22 331 04 52 0             | 3              |                              | Scheibe Disc                         |                             |
| 33  | 506 833 0                  | 1              | SW42                         | Sprengtring Spring ring              |                             |

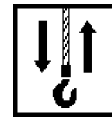

| Pos | Teil-Nummer<br>Part-Number | Stück<br>Piece | Beschreibung<br>Description | Benennung<br>Designation | Designation            |
|-----|----------------------------|----------------|-----------------------------|--------------------------|------------------------|
| 35  | 45 330 50 37 0             | 1              | 6) (Pos.36,37,39,40)        | Motordeckel              | Motor cover            |
| 36  | 561 947 0                  | 1              | A42x56x7                    | Wellendichtring          | Shaft seal             |
| 37  | 560 826 0                  | 1              | Nu1007-C3                   | Zyl-Rollenlager          | Roller bearing         |
| 38  | 506 832 0                  | 1              | SW35                        | Sprengring               | Spring ring            |
| 39  | 506 108 0                  | 1              | 62x2                        | Sicherungsring           | Locking ring           |
| 40  | 561 964 0                  | 1              | AS35x62x12                  | Wellendichtring          | Shaft seal             |
| 43  | 21 253 00 98 0             | 1              |                             | Stopfen                  | Plug                   |
| 45  | 500 307 0                  | 4              | M10x35                      | Zyl-Schraube             | Socket head cap screw  |
| 46  | 506 904 0                  | 4              | 10                          | Federring                | Spring washer          |
| 48  | 45 330 00 18 0             | 1              |                             | Bremsscheibe             | Brake disc             |
| 50  | 45 331 00 36 0             | 1              |                             | Bremshaube               | Brake cap              |
| 52  | 500 307 0                  | 4              | M10x35                      | Zyl-Schraube             | Socket head cap screw  |
| 53  | 506 904 0                  | 4              | 10                          | Federring                | Spring washer          |
| 55  | 45 331 00 91 0             | 1              |                             | Mutter                   | Nut                    |
| 56  | 45 330 00 17 0             | 1              |                             | Lüfterrad                | Fan wheel              |
| 57  | 500 234 0                  | 4              | M8x25                       | Zyl-Schraube             | Socket head cap screw  |
| 58  | 507 028 0                  | 4              | Gr.8                        | Sicherungsscheibe        | Locking disc           |
| 60  | 45 331 00 40 0             | 1              |                             | Lüfterhaube              | Fan cowling            |
| 62  | 500 419 0                  | 4              | M5x8                        | Skt-Schraube             | Hexagon head cap screw |
| 63  | 506 042 0                  | 4              | A5                          | Federring                | Spring washer          |
| 75  | 500 307 0                  | 4              | M10x35                      | Zyl-Schraube             | Socket head cap screw  |
| 76  | 506 904 0                  | 4              | 10                          | Federring                | Spring washer          |
| 80  | 43 330 01 80 0             | 1              | (Pos.81)                    | Typenschild              | Type plate             |
| 81  | 507 831 0                  | 4              | 3x5                         | Blindniet                | Blind rivet            |
| 100 | 45 330 00 15 0             | 1              | (Pos.101-118)               | Klemmenkasten            | Terminal box           |
| 101 | 500 233 0                  | 3              | M6x16                       | Zyl-Schraube             | Socket head cap screw  |
| 102 | 506 335 0                  | 3              | 6                           | Federring                | Spring washer          |
| 103 | 02 220 00 21 0             | 1              | (Pos.104,105)               | Anschlußkastendeckel     | Terminal box cover     |
| 104 | 506 900 0                  | 4              | 5                           | Federring                | Spring washer          |
| 105 | 502 072 0                  | 4              | M5x20                       | Zyl-Schraube             | Cheese head cap screw  |
| 106 | 45 331 00 95 0             | 1              |                             | Dichtung                 | Seal                   |
| 108 | 506 374 0                  | 2              | 4                           | Federring                | Spring washer          |
| 109 | 502 051 0                  | 2              | M4x8                        | Zyl-Schraube             | Cheese head cap screw  |
| 110 | 518 003 0                  | 1              | Pg21                        | Verschlußstopfen         | Plug                   |
|     | 518 942 0                  | 1              | 24x2                        | Runddichtring            | Round sealing ring     |
| 111 | 518 018 0                  | 1              | Pg 16                       | Verschlußstopfen         | Plug                   |
|     | 518 860 0                  | 1              | 20x2                        | Runddichtring            | Round sealing ring     |
| 112 | 502 012 0                  | 2              | M4x8                        | Senkschraube             | Countersunk screw      |
| 113 | 45 330 31 89 0             | 1              |                             | Klemmbrett               | Terminal bord          |
| 116 | 519 214 0                  | 1              | Pg 21                       | Kabelverschraubung       | Conduit gland          |
|     | 518 942 0                  | 1              | 24x2                        | Runddichtring            | Round sealing ring     |
| 117 | 519 213 0                  | 1              | Pg 16                       | Kabelverschraubung       | Conduit gland          |
|     | 518 860 0                  | 1              | 20x2                        | Runddichtring            | Round sealing ring     |
| 118 | 518 019 0                  | 1              | Pg 29                       | Kabelverschraubung       | Conduit gland          |
|     | 518 943 0                  | 1              | 33x2                        | Runddichtring            | Round sealing ring     |

- 1) Bitte Betriebsspannung und Frequenz angeben.
- 2) Bitte Seilzug Typ angeben.
- 3) Pos.18 immer mitbestellen
- 4) Verwendung nach Bedarf
- 5) Pos.28,29 und 32 immer mitbestellen
- 6) Pos.43 immer mitbestellen

- 1) Please state voltage and frequency.
- 2) Please state wire rope hoist type.
- 3) Always include item 18 in order
- 4) As required
- 5) Always include items 28,29 and 32 in order
- 6) Always include item 43 in order